

Assembling

STEP 1: Removing the chair

- Remove the chair from the box.
- 2 People are needed to lift up the chair, use the holding areas as indicated below.

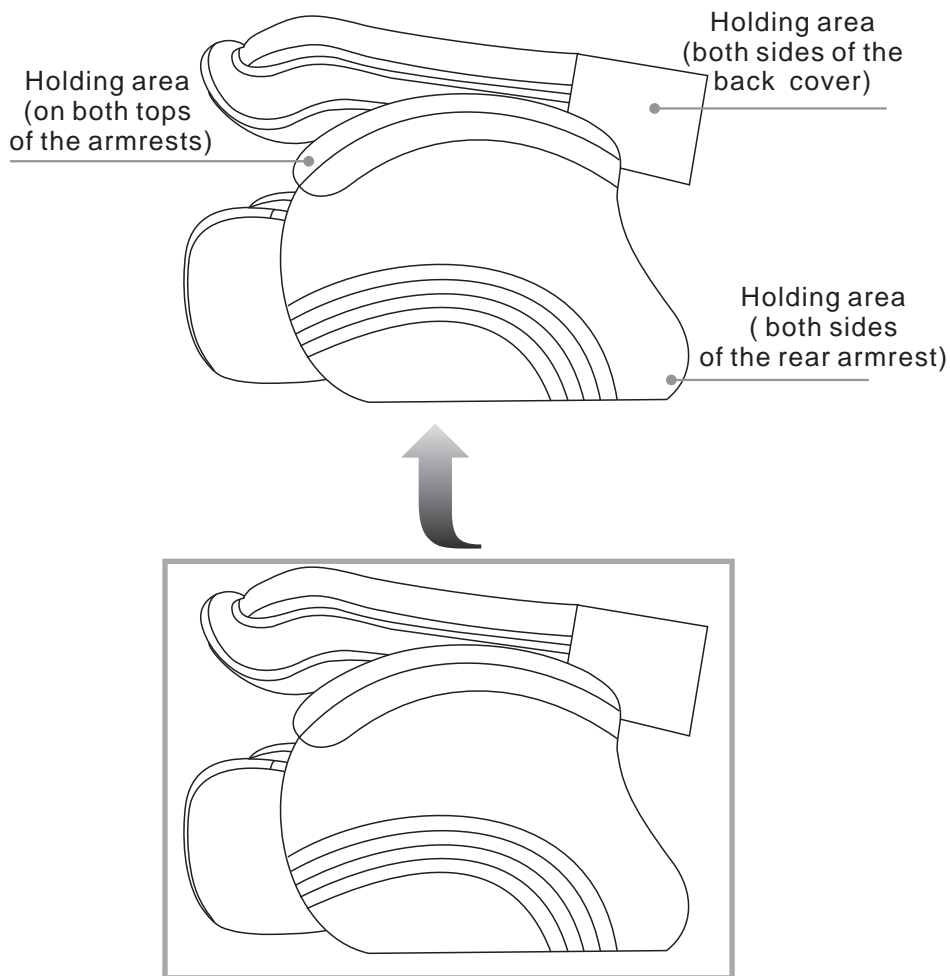

Assembling

STEP 2: Setting up the Massage Chair

- When the massage chair is removed from the carton box, raise the backrest.
- Raise the backrest to approx. 120°, until a "CLICK" Sound is heard, to fix the backrest into position.

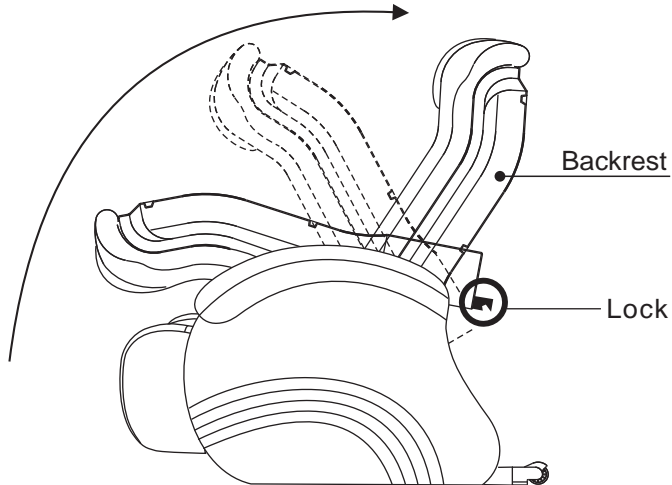

STEP 3: Setting up the Back Pad

- Place the back pad against the backrest (DO NOT attach the zipper at this point)

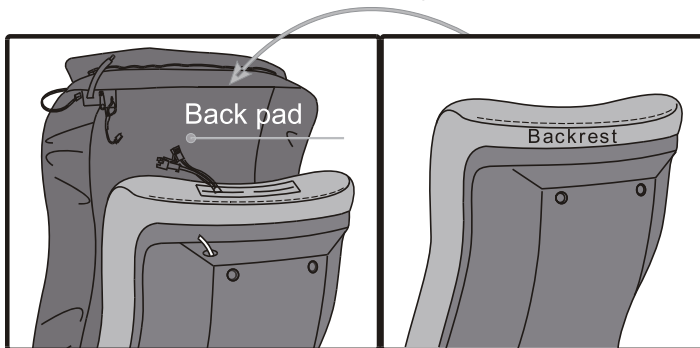

Assembling

STEP 4: Setting up the Back warmer & Back Air Pipe

- Attach the wire from the back pad (Male end) to the one from the backrest (Female end) .
- Insert the spare length of wire into the gap on the top of backrest, and zip up the zipper.

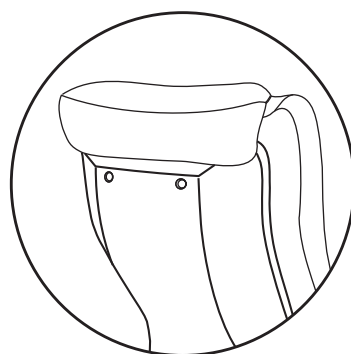
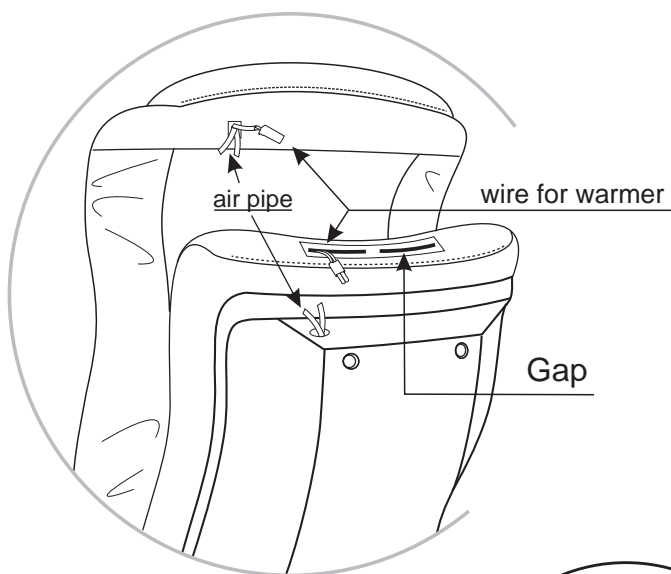

Finished

Assembling

STEP 5: Remote Control Pocket and Setting up the Back Pad

- The remote control can be stored when not in use in this pocket behind the back pad.
- Foam pads are included which can be added and removed to increase or decrease the intensity of the massage for different users or when not using the chair for massage purposes.

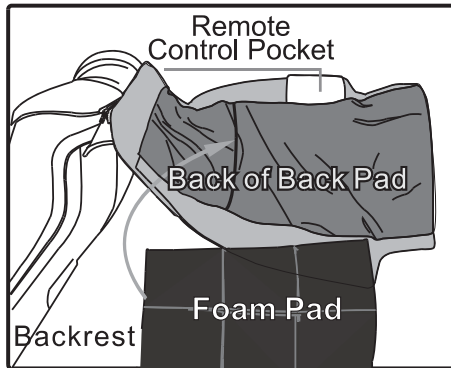

STEP 6: Main Power Setup

- Insert the power cord per the diagram below:
(Put in the upper portion of the switch labeled I to turn on the power)
(Push in the lower half of the switch labeled O to turn off the power)
- Ensure that there are no obstacles or obstructions to the backrest and the footrest prior to adjusting their position.

